



3-pole, 10 A 0-I

Technical data

Ex-Main current switches 10 A

Marking accd. to 2014/34/EU	Ⓔ II 2 G Ex de IIC T6 / Ⓔ II 2 D Ex tD A21 IP66 T80 °C	
EC-Type Examination Certificate	PTB 00 ATEX 1074	
IECEX Certificate of Conformity	BKI 07.0014	
Marking accd. to IECEx	Ex ed IIC T6 Ex tD A21 IP66 T53 °C	
Permissible ambient temperature	-20 °C up to +40 °C ¹⁾	
Rated voltage	up to max. 500 V	
Rated current	max. 10 A	
Frequency	50/60 Hz	
Rated making/breaking capacity AC-3 accd. EN 60947-3	U _e 230 V / I _e 10 A U _e 400 V / I _e 10 A U _e 500 V / I _e 10 A	
Back-up fuse	up to 400 V AC: 10 A gG up to 500 V AC: 10 A gG	
Connecting terminals	main contact	2 x 1.5 - 2.5 mm ²
	auxiliary/signal contact	2 x 0.5 - 2.5 mm ²
Protection class	I	
Degree of protection accd. to EN 60529	IP66	
Cable glands/enclosure drilling	M25 cable gland see ordering details	
Weight	approx. 0.60 kg	
Enclosure material	impact resistant polyamide	
Enclosure colour	black	
Padlocking facility	can be locked in OFF position with 3 commercially available padlocks (Ø max. 6 mm) optional	

¹⁾ Other ambient temperatures on request

GHG 261 - Ex-main current switches 10 A



3-pole, 10 A 0-I

Ordering details

5

Content	Cable gland		Order No.
Ex-Main current switches 10 A			
3-pole 0-I	2 x M25	ON-OFF switch	GHG 261 0006 R0001
Customized version on request			

Accessories

Type	Application	Fixing method	Order No.
Mounting plate for Ex-Main current switches 10 A 3-pole			
Size 1	Wall mounting	screwless mounting	GHG 610 1953 R0101
Size 1	Pipe clamp	screwless mounting	GHG 610 1953 R0102
Size 1	Trellis-work mounting	screwless mounting	GHG 610 1953 R0103

Type		OU	Order No.
Accessories for mounting plates			
	Label holder with type label (blank) for mounting plate size 1, 2, 2A and 3	10	GHG 610 1953 R0057
	Mounting set for pipes 1" (of 27 - 30 mm) for mounting plates with pipe fixing	10	GHG 610 1953 R0020

Type	Application	OU	Order No.
Protective canopy for mounting plate			
Size 1	for mounting plate size 1	1	GHG 610 1955 R0101

Please pay attention that only order units (OU) according to the ordering details can be delivered.

Dimension drawing

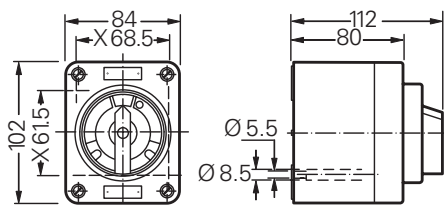

3-pole, 10 A 0-I

X = fixing dimensions

Dimensions in mm