

QX-02... Overview

Overview Local Control Components

Erfahrung ist Zukunft



Local Control Components



Switching Module:

Marking:

⊕ II 2G Ex de IIC Gb

⊕ II 2D Ex tD A21 IP66

ATEX, IECEX, EAC TC-RU

Zone 1 / 2 / 21 / 22

T_a -55..+60°C

Electrical data:

U 250 V 250 V 110 V 24 V

Use AC12 AC15 DC13 DC13

I 16 A 10A 0.5A 1A

T_a ≤ 40°C ≤ 60°C ≤ 60°C ≤ 60°C

Switching cycles ≥ 1.000.000

Mounting: DIN-rail 35mm,
Mounting plate, Lid

Signal Lamp:

Marking:

⊕ II 2G Ex de IIC Gb

⊕ II 2D Ex tD A21 IP66

ATEX, IECEX, EAC TC-RU

Zone 1 / 2 / 21 / 22

T_a -55..+60°C, P_{max} ≤ 1W

Electrical data:

U: 20-250V AC/DC,

Optional: 12-28V DC

Optional: 250-400V AC

Mounting: DIN-rail 35mm,
Mounting plate, Lid

Illuminated Push Button:

Marking:

⊕ II 2G Ex de IIC Gb

⊕ II 2D Ex tD A21 IP66

ATEX, IECEX, EAC TC-RU

Zone 1 / 2 / 21 / 22

T_a -55..+60°C, P_{max} ≤ 1W

U 250 V 24 V

Use AC15 DC13

I 6A 1A

Electrical data:

U: 20-250V AC/DC

Mounting: DIN-rail 35mm,
Mounting plate, Lid

QX-0201-P1+2...

Ex Pushbutton / Double-Pushbutton



Local Control Components



- High switching capacity
- International certificates
- Different inlay symbols and colours
- Robust construction

Description

Pushbutton / Double-Pushbutton for assembling of control panels or local control stations. Robust and reliable construction with 2,5mm² silver contact terminals and nominal voltage up to 250V.

There are different coloured inlays or symbols available.

With the Double-Pushbutton 2 functions can be realized on small space.



Possible Application

- Control Panels
- Local control stations

Technical Data

Zone:	1 / 2 / 21 / 22
Nominal voltage max.:	250VAC / 110VDC
Current @ 250VAC:	AC12: 16A @ ≤40°C AC15: 10A @ ≤60°C
Current @ 110VDC:	DC12: 0,5A @ ≤60°C
Current @ 24VDC:	DC13: 1A @ ≤60°C
Terminals:	2x 2,5mm ² , Silver
Ingress protection:	IP 66
Temperature range:	-55..+60°C
Dimension (mm):	pls. see drawing
Mechanical life:	1.000.000 cycles
Mounting possibilities:	Backside – DIN-Rail Lid
Lid Mounting:	Thickness 1-6mm

Certificates

ATEX, IECEx, EAC TC-RU

Marking

⊕ II 2G Ex de IIC Gb / ⊕ II 2D Ex tD A21 IP66

QX-0201-P1+2...

Ex Pushbutton / Double-Pushbutton



Local Control Components



Order numbers:

P1 = Single-Pushbutton / P2 = Double-Pushbutton

Rail-mounting		QX-0201-P_ 60
		QX-0201-P_ 61
		QX-0201-P_ 62
Lid-mounting		QX-0201-P_ 70
		QX-0201-P_ 71
		QX-0201-P_ 72

Following inlay symbols and colours are available. Please add the code on your order.

Code	Colour of label	Engraved	colour of text
01	green		
02	green	I	white
03	green	ON	white
04	green	START	white
Q1	green	EIN	white
21	red		
22	red	O	white
23	red	OFF	white
24	red	STOP	white
Q2	red	AUS	white
41	white		
42	white	II	black
43	white	↑	black
44	white	START	black
45	white	STOP	black
46	white	FW	black
47	white	BW	black
48	white	STOP	red
49	white	↑↑	black
61	yellow		
62	yellow	II	white
81	black		
91	blue		

Dimensional drawings

Pushbutton QX-0201-P1...

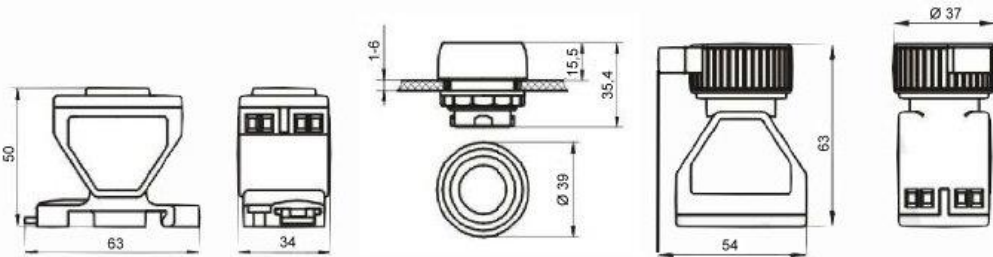

Double-Pushbutton QX-0201-P2...

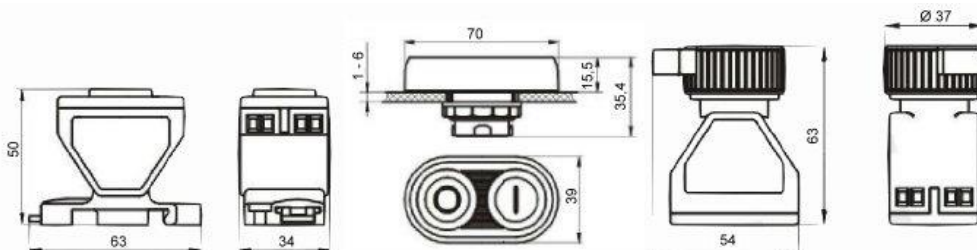

QX-0201-P3...

Ex Emergency Stop Button



Local Control Components



- High switching capacity
- Release by pulling
- International certificates
- Robust construction

Description

Emergency Stop button for assembling of control panels or local control stations. Robust and reliable construction with 2,5mm² silver contact terminals and nominal voltage up to 250V. Different switching combinations are possible. With yellow ring for showing the emergency function.

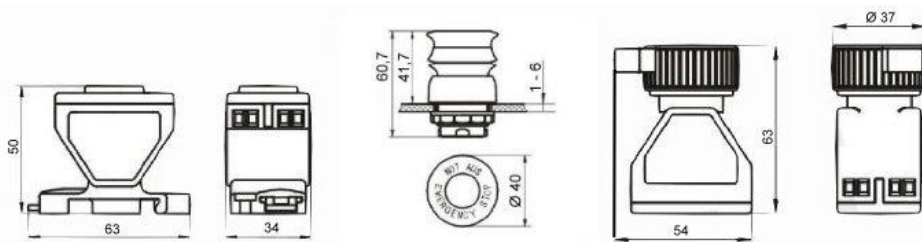

Possible Application

- Control Panels
- Local control stations

Technical Data

Zone: 1 / 2 / 21 / 22
 Nominal voltage max.: 250VAC / 110VDC
 Current @ 250VAC: AC12: 16A @ ≤40°C
 AC15: 10A @ ≤60°C
 Current @ 110VDC: DC12: 0,5A @ ≤60°C
 Current @ 24VDC: DC13: 1A @ ≤60°C
 Terminals: 2x 2,5mm², Silver
 Ingress protection: IP 66
 Temperature range: -55..+60°C
 Dimension (mm): pls. see drawing
 Mechanical life: 1.000.000 cycles
 Mounting possibilities: Backside – DIN-Rail
 Lid
 Lid Mounting: Thickness 1-6mm

Certificates

ATEX, IECEX, EAC TC-RU
 Acc. standard EN 60947-5-5

Marking

Ⓔ II 2G Ex de IIC Gb / Ⓔ II 2D Ex tD A21 IP66

Order no.

Rail mounting		QX-0201-P3 60
		QX-0201-P3 61
		QX-0201-P3 62
Lid mounting		QX-0201-P3 70
		QX-0201-P3 71
		QX-0201-P3 72

QX-0201-P6... / -P7...

Ex Emergency Stop Button



Local Control Components



- High switching capacity
- Release twisting
- International certificates
- Robust construction

Description

Emergency Stop button for assembling of control panels or local control stations. Robust and reliable construction with 2,5mm² silver contact terminals and nominal voltage up to 250V. Different switching combinations are possible. With yellow ring for showing the emergency function.

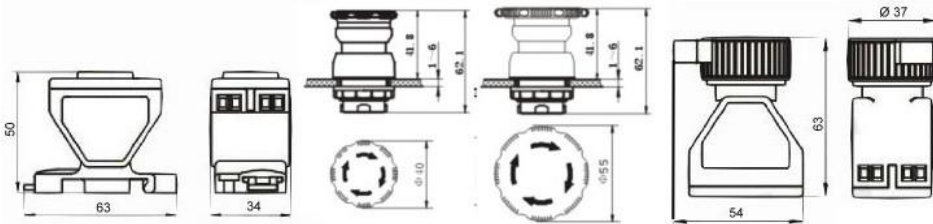
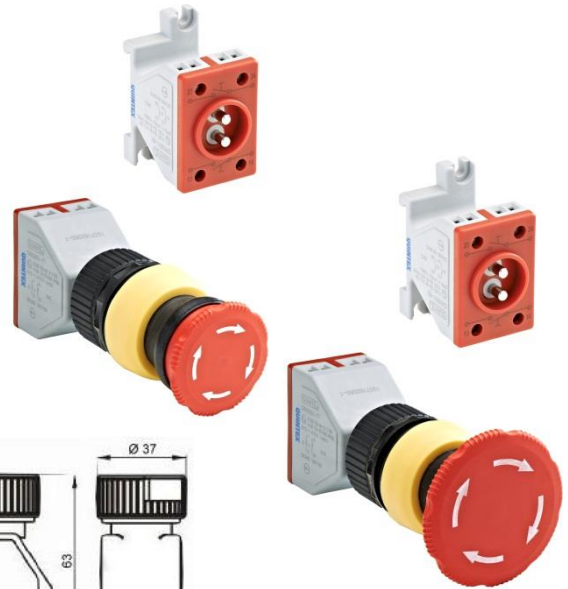

Possible Application

- Control Panels
- Local control stations

Technical Data

Zone:	1 / 2 / 21 / 22
Nominal voltage max.:	250VAC / 110VDC
Current @ 250VAC:	AC12: 16A @ ≤40°C AC15: 10A @ ≤60°C
Current @ 110VDC:	DC12: 0,5A @ ≤60°C
Current @ 24VDC:	DC13: 1A @ ≤60°C
Terminals:	2x 2,5mm ² , Silver
Ingress protection:	IP 66
Temperature range:	-55..+60°C
Dimension (mm):	pls. see drawing
Mechanical life:	1.000.000 cycles
Mounting possibilities:	Backside – DIN-Rail Lid
Lid Mounting:	Thickness 1-6mm

Certificates

ATEX, IECEx, EAC TC-RU

Marking

⊕ II 2G Ex de IIC Gb / ⊕ II 2D Ex tD A21 IP66

Order no.

P6 = small knob 40mm / P7 = large knob 55mm

Rail mounting		QX-0201-P_ 60
		QX-0201-P_ 61
		QX-0201-P_ 62
Lid mounting		QX-0201-P_ 70
		QX-0201-P_ 71
		QX-0201-P_ 72

QX-0201-P4...

Ex Mushroom Pushbutton black



Local Control Components



- High switching capacity
- International certificates
- Different inlay symbols and colours
- Robust construction

Description

Mushroom Pushbutton for assembling of control panels or local control stations.

Robust and reliable construction with 2,5mm² silver contact terminals and nominal voltage up to 250V.

There are different coloured inlays or symbols available.

Different switching combinations are possible.

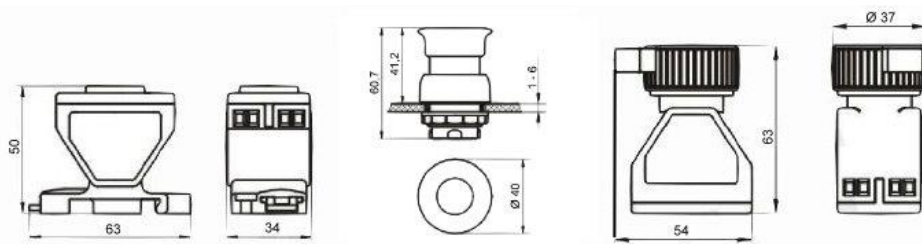

Possible Application

- Control Panels
- Local control stations

Technical Data

Zone:	1 / 2 / 21 / 22
Nominal voltage max.:	250VAC / 110VDC
Current @ 250VAC:	AC12: 16A @ ≤40°C AC15: 10A @ ≤60°C
Current @ 110VDC:	DC12: 0,5A @ ≤60°C
Current @ 24VDC:	DC13: 1A @ ≤60°C
Terminals:	2x 2,5mm ² , Silver
Ingress protection:	IP 66
Temperature range:	-55..+60°C
Dimension (mm):	pls. see drawing
Mechanical life:	1.000.000 cycles
Mounting possibilities:	Backside – DIN-Rail Lid
Lid Mounting:	Thickness 1-6mm

Certificates

ATEX, IECEx, EAC TC-RU

Marking

Ⓔ II 2G Ex de IIC Gb / Ⓔ II 2D Ex tD A21 IP66

Order no.

Rail mounting		QX-0201-P4 60
		QX-0201-P4 61
		QX-0201-P4 62
Lid mounting		QX-0201-P4 70
		QX-0201-P4 71
		QX-0201-P4 72

QX-0201-K/S...

Ex Selector switch 2-pole



Local Control Components



- High switching capacity
- Small and large handles available
- International certificates
- Robust construction

Description

Selector switch for assembling of control panels or local control stations.

Robust and reliable construction with 2,5mm² silver contact terminals and nominal voltage up to 250V.

Different switching combinations are possible.

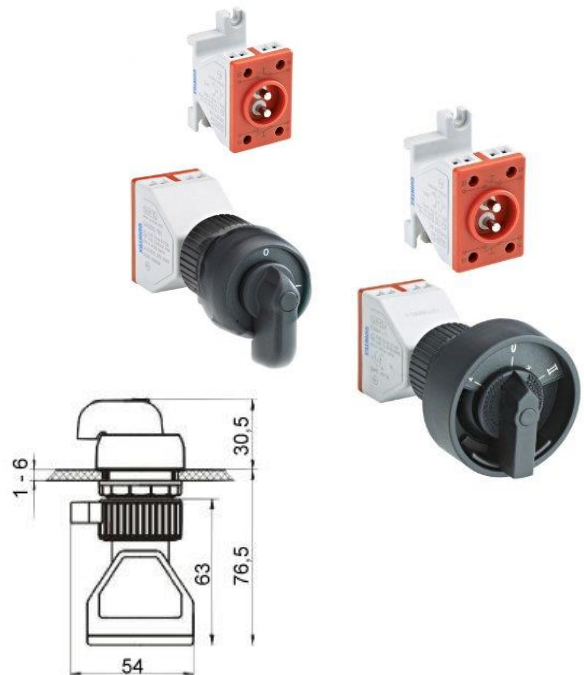
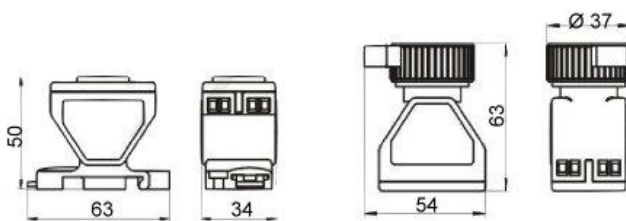

Possible Application

- Control Panels
- Local control stations

Technical Data

Zone:	1 / 2 / 21 / 22
Nominal voltage max.:	250VAC / 110VDC
Current @ 250VAC:	AC12: 16A @ ≤40°C AC15: 10A @ ≤60°C
Current @ 110VDC:	DC12: 0,5A @ ≤60°C
Current @ 24VDC:	DC13: 1A @ ≤60°C
Terminals:	2x 2,5mm ² , Silver
Ingress protection:	IP 66
Temperature range:	-55..+60°C
Dimension (mm):	pls. see drawing
Mechanical life:	1.000.000 cycles
Mounting possibilities:	Backside – DIN-Rail Lid
Lid Mounting:	Thickness 1-6mm

Certificates

ATEX, IECEx, EAC TC-RU

Marking

⊕ II 2G Ex de IIC Gb / ⊕ II 2D Ex tD A21 IP66

Dimensional drawing of heads

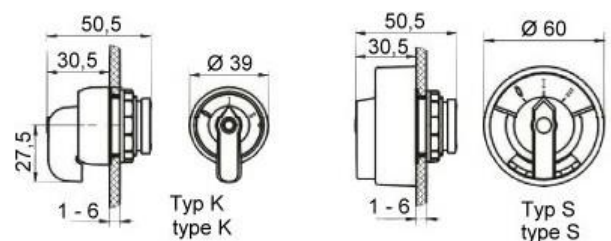

QX-0201-K/S...

Ex Selector switch 2-pole





Local Control Components



Order numbers

Please see table for order numbers:

Contact Scheme	Ø 39mm	Ø 60mm	Mounting
			
0-I-II	K4 60 03	QX-0201- S4 60 03	Rail
	K4 70 03	S4 70 03	Lid
I-0-II	K4 62 04	S4 62 04	Rail
	K4 72 04	S4 72 04	Lid
I-0-II	K5 62 04	S5 62 04	Rail
	K5 72 04	S5 72 04	Lid
0-I-II	K5 60 03	S5 60 03	Rail
	K5 70 04	S5 70 03	Lid
0 - I	K6 62 01	S6 62 01	Rail
	K6 72 01	S6 72 01	Lid
I - II	K6 60 02	S6 60 02	Rail
	K6 70 02	S6 70 02	Lid
0 . I	K8 60 05	S8 60 05	Rail
	K8 70 05	S8 70 05	Lid

The labels of the switching handle can be changed according requested.
Therefore use the last digits of the needed label

e.g.: instead of **0 • I** at S8 60 05
you wish to use **I 0 II** (but same contact scheme)
order number will be: S8 60 04

QX-0201-P/S..5...

Ex Switching component 4-pole



Local Control Components



- High switching capacity
- International certificates
- Small and large handles available
- Robust construction

Description

4-pole switching component for assembling of control panels or local control stations. Robust and reliable construction with 2,5mm² silver contact terminals and nominal voltage up to 250V.

Different switching combinations are possible. This component can be used with different push button heads as well as different heads and functions of selector switches.



Possible Application

- Control Panels
- Local control stations

Technical Data

Zone:	1 / 2 / 21 / 22
Nominal voltage max.:	250VAC / 110VDC
Current @ 250VAC:	AC12: 16A @ ≤40°C AC15: 10A @ ≤60°C
Current @ 110VDC:	DC12: 0,5A @ ≤60°C
Current @ 24VDC:	DC13: 1A @ ≤60°C
Terminals:	2x 2,5mm ² , Silver
Ingress protection:	IP 66
Temperature range:	-55..+60°C
Dimension (mm):	pls. see drawing
Mechanical life:	1.000.000 cycles
Mounting possibilities:	Backside – DIN-Rail Lid
Lid Mounting:	Thickness 1-6mm

Certificates

ATEX, IECEx, EAC TC-RU

Marking

⊕ II 2G Ex de IIC Gb / ⊕ II 2D Ex tD A21 IP66

Dimensional drawing

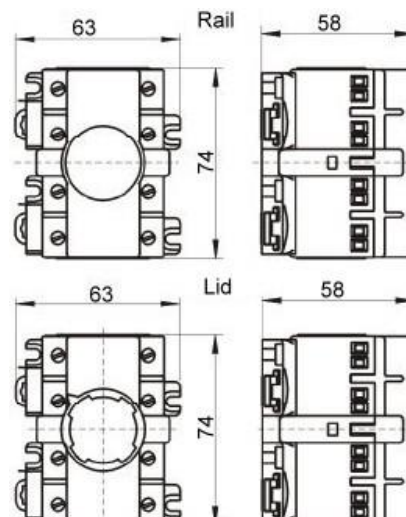

QX-0201-P/S..5...

Ex Switching component 4-pole

Local Control Components



Order No.

		Contact Scheme		Order Number QX-0201-					
		2 NC / 2 NO	□□ □50 □□						
		4 NC	□□ □51 □□						
		4 NO	□□ □52 □□						
		1 NC / 3 NO	□□ □53 □□						
		3 NC / 1 NO	□□ □54 □□						
6 – rail mounting 7 – lid mounting Code only for insert of pushbutton QX-P1									
Code →	P1 Pushbutton	P2 Double-Pushbutton	P3 Emergency-stop pull	P6 Emergency-stop twist	P7 Emergency-stop large, twist	P4 Mushroom button	Y0 Mushroom button, red	Y5 Key switch I-0-II	Y6 Key switch 0-I
Operator									

		Contact Scheme		Order Number QX-0201-	
 	I - II			S6 □50 02	
	0 - I			S6 □52 01	
	0 - I			S6 □54 01	
	I-0-II			S4 □52 04	
	I-0-II			S5 □52 04	
	I-0-II			S8 □52 04	
	0-I-II			S4 □50 03	
	0-I-II			S5 □50 03	
0 . I			S8 □50 05		
6 – rail mounting 7 – lid mounting					

The markings of the handle can be interchanged.
 Simply use the last two digits of that image.
 E.g.: instead of **0 • I** at S8 6 50 **05** it should be **I 0 II**
 adapted order number: S8 6 50 **04**

QX-0201-Y0...

Ex Emergency Stop / Mushroom Pushbutton with key, red



Local Control Components



- High switching capacity
- Usable as latching or spring return
- International certificates
- Robust construction

Description

Emergency Stop / Mushroom Pushbutton with key for assembling of control panels or local control stations.

Robust and reliable construction with 2,5mm² silver contact terminals and nominal voltage up to 250V.

Different switching combinations are possible.

The key can be removed in both positions.

Used as Emergency function only with key releasable.

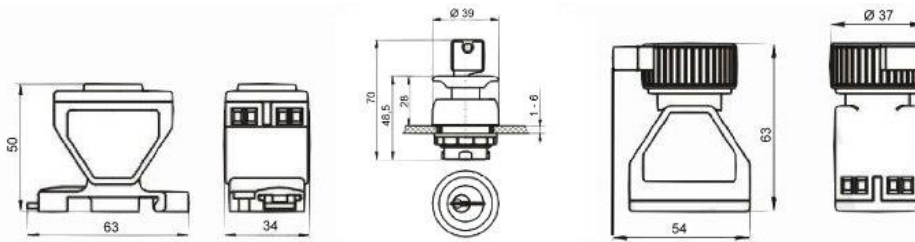

Possible Application

- Control Panels
- Local control stations

Certificates

ATEX, IECEx, EAC TC-RU

Technical Data

Zone:	1 / 2 / 21 / 22
Nominal voltage max.:	250VAC / 110VDC
Current @ 250VAC:	AC12: 16A @ ≤40°C AC15: 10A @ ≤60°C
Current @ 110VDC:	DC12: 0,5A @ ≤60°C
Current @ 24VDC:	DC13: 1A @ ≤60°C
Terminals:	2x 2,5mm ² , Silver
Ingress protection:	IP 66
Temperature range:	-55..+60°C
Dimension (mm):	pls. see drawing
Mechanical life:	1.000.000 cycles
Mounting possibilities:	Backside – DIN-Rail Lid
Lid Mounting:	Thickness 1-6mm

Marking

Ⓔ II 2G Ex de IIC Gb / Ⓔ II 2D Ex tD A21 IP66

Order no.

Rail mounting		QX-0201-Y0 60
		QX-0201-Y0 61
		QX-0201-Y0 62
Lid mounting		QX-0201-Y0 70
		QX-0201-Y0 71
		QX-0201-Y0 72

QX-0201-Y6... / -Y5...

Ex Key Switch



Local Control Function



- High switching capacity
- Usable as latching or spring return
- International certificates
- Robust construction

Description

Key switch for assembling of control panels or local control stations.

Robust and reliable construction with 2,5mm² silver contact terminals and nominal voltage up to 250V.

Different switching combinations are possible.

The key can be removed in both positions.

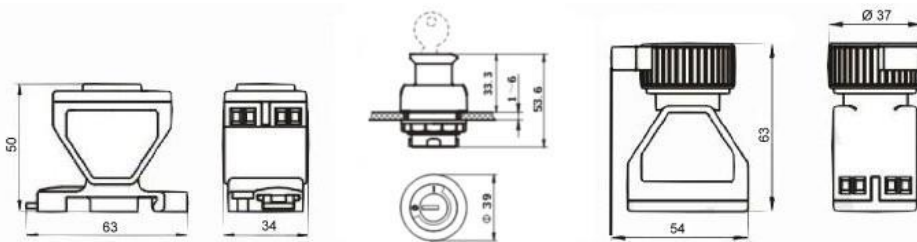

Possible Application

- Control Panels
- Local control stations

Technical Data

Zone:	1 / 2 / 21 / 22
Nominal voltage max.:	250VAC / 110VDC
Current @ 250VAC:	AC12: 16A @ ≤40°C AC15: 10A @ ≤60°C
Current @ 110VDC:	DC12: 0,5A @ ≤60°C
Current @ 24VDC:	DC13: 1A @ ≤60°C
Terminals:	2x 2,5mm ² , Silver
Ingress protection:	IP 66
Temperature range:	-55..+60°C
Dimension (mm):	pls. see drawing
Mechanical life:	1.000.000 cycles
Mounting possibilities:	Backside – DIN-Rail Lid
Lid Mounting:	Thickness 1-6mm

Certificates

ATEX, IECEX, EAC TC-RU

Marking

⊕ II 2G Ex de IIC Gb / ⊕ II 2D Ex tD A21 IP66

Order no.

Y6 = 0-I / Y5 = I-0-II

Rail mounting		QX-0201-Y_ 60
		QX-0201-Y_ 61
		QX-0201-Y_ 62
Lid mounting		QX-0201-Y_ 70
		QX-0201-Y_ 71
		QX-0201-Y_ 72



- High luminance
- Wide supply voltage range
- International certificates
- Robust construction

Description

Indication lamp for assembling of control panels or local control stations.

Robust and reliable construction with 2,5mm² silver contact terminals and nominal voltage up to 250V.

Because of the high luminance they are usable within daylight.

Low power consumption because of LED technique. Different colours are available.

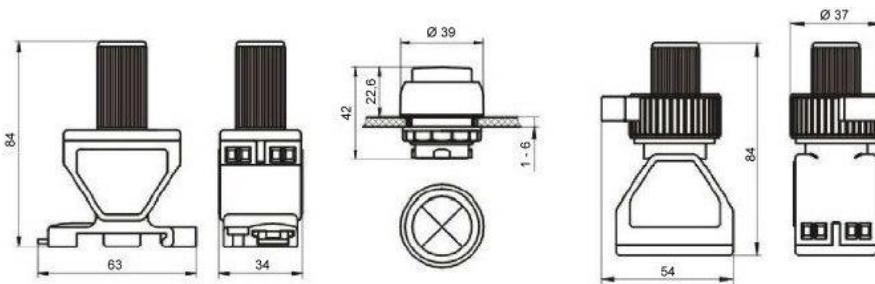

Possible Application

- Control Panels
- Local control stations

Technical Data

Zone:	1 / 2 / 21 / 22
Nominal Voltage:	20-250V AC/DC
Optional:	12-28V AC/DC 250-400V AC
Terminals:	2x 2,5mm ² , Silver contact
Ingress protection:	IP 66
Temperature range:	-55..+60°C
Power consumption:	≤1W
Dimension (mm):	pls. see drawing
Lifetime:	100.000 h
Mounting possibilities:	Backside – DIN-Rail Lid
Lid Mounting:	Thickness 1-6mm

Certificates

ATEX, IECEx, EAC TC-RU

Marking

Ex II 2G Ex de IIC Gb / Ex II 2D Ex tD A21 IP66

Order no.

Rail mounting	Lid mounting	Colour
QX-0202-LR60x	QX-0202-LR70x	Red
QX-0202-LG60x	QX-0202-LG70x	Green
QX-0202-LY60x	QX-0202-LY70x	Yellow
QX-0202-LB60x	QX-0202-LB70x	Blue
QX-0202-LW60x	QX-0202-LW70x	White

x = 1: 20-250V AC/DC
 x = 2: 250-400V AC
 x = 3: 12-28V AC/DC

QX-0212-...

Ex Illuminated Pushbutton



Local Control Components



- High luminance
- Wide supply voltage range
- International certificates
- Robust construction

Description

Illuminated Pushbutton for assembling of control panels or local control stations.

Robust and reliable construction with 2,5mm² silver contact terminals and nominal voltage up to 250V.

Because of the high luminance they are usable within daylight.

Low power consumption because of LED technique. Different colours are available.

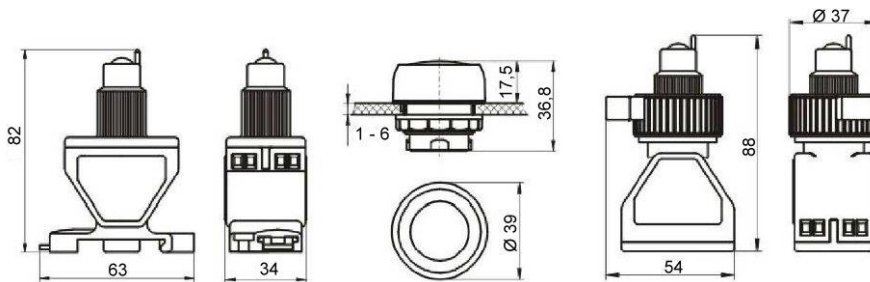

Possible Application

- Control Panels
- Local control stations

Technical Data

Zone:	1 / 2 / 21 / 22
Nominal Voltage:	20-250V AC/DC
optional:	12-28V AC/DC
Switching capacity:	AC15: 6A @ 250V DC13: 1A @ 24V
Terminals:	2x 2,5mm ² , Silver contact
Ingress protection:	IP 66
Temperature range:	-55..+60°C
Power consumption:	≤1W
Dimension (mm):	pls. see drawing
Mechanical life:	300.000 cycles
Mounting possibilities:	Backside – DIN-Rail Lid
Lid Mounting:	Thickness 1-6mm

Certificates

ATEX, IECEx, EAC TC-RU

Marking

Ex II 2G Ex de IIC Gb / Ex II 2D Ex tD A21 IP66

Order no.

Rail	Lid	Colour	Contact
QX-0212-..	QX-0212-..		
..PR630x	..PR730x	Red	
..PG630x	..PG730x	Green	
..PY630x	..PY730x	Yellow	
..PB630x	..PB730x	Blue	
..PW630x	..PW730x	White	
..PR640x	..PR740x	Red	
..PG640x	..PG740x	Green	
..PY640x	..PY740x	Yellow	
..PB640x	..PB740x	Blue	
..PW640x	..PW740x	White	

x=1: 20-250V AC/DC x=3: 12-28V AC/DC

QX-0203-DW...

Ex Potentiometer



Local Control Components



- Wide value range
- Exact adjustable
- International certificates
- Robust construction

Description

Potentiometer for assembling of control panels or local control stations.
Robust and reliable construction with 2,5mm² silver contact terminals and nominal voltage up to 250V.
The Potentiometer has got 3-poles, adjustable from 0 to 100%.

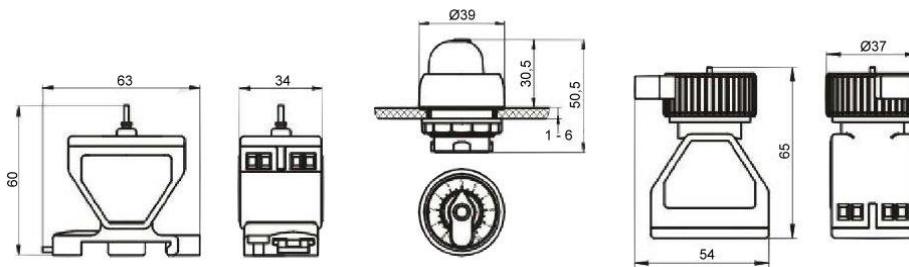

Possible Application

- Control Panels
- Local control stations

Certificates

ATEX, IECEx, EAC TC-RU

Technical Data

Zone:	1 / 2 / 21 / 22
Nominal Voltage max.:	200VDC
Power max.:	0,1W
Terminals:	2x 2,5mm ² , Silver
Ingress protection:	IP 66
Temperature range:	-55..+60°C
Dimension (mm):	pls. see drawing
Range:	0-100%
Mounting possibilities:	Backside – DIN-Rail Lid
Lid Mounting:	Thickness 1-6mm

Marking

Ex II 2G Ex de IIC Gb / Ex II 2D Ex tD A21 IP66

Order no.

x = 6: Rail mounting / x = 7: Lid mounting

Value	Order number
100 Ω	QX-0203-DWx01
200 Ω	QX-0203-DWx02
500 Ω	QX-0203-DWx03
1.000 Ω	QX-0203-DWx04
2.000 Ω	QX-0203-DWx05
5.000 Ω	QX-0203-DWx06
10.000 Ω	QX-0203-DWx07
20.000 Ω	QX-0203-DWx08
50.000 Ω	QX-0203-DWx09
100.000 Ω	QX-0203-DWx10
200.000 Ω	QX-0203-DWx11
500.000 Ω	QX-0203-DWx12
1.000.000 Ω	QX-0203-DWx13
2.000.000 Ω	QX-0203-DWx14

QX-0205...

Ex Ampere- / Voltmeter



Local Control Components



- Wide measurement range
- Moving iron instrument
- International certificates
- Robust construction

Description

Ampere- / Voltmeter for assembling of control panels or local control stations.

Robust and reliable construction with 2,5mm² terminals.

Direct and indirect measurement (by current transformer) available.

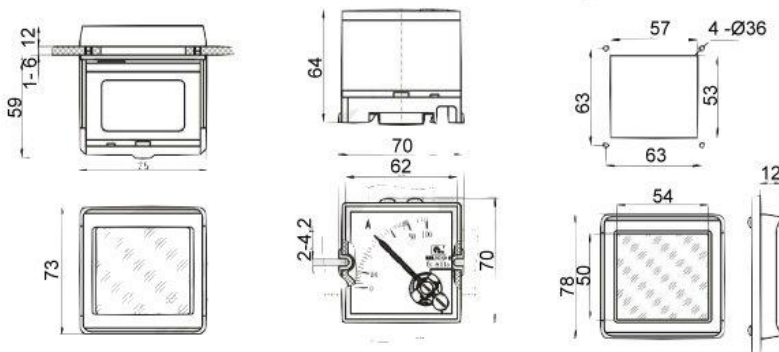

Possible Application

- Control Panels
- Local control stations

Technical Data

Zone: 1 / 2 / 21 / 22
Measurement range: pls. see table
Accuracy class: 1,5
For current transformer: 1 or 5A
Overload scale factor: 2 or 5-fold
Terminals: 2x 2,5mm², Silver
Ingress protection: IP 66
Temperature range: -55..+60°C
Dimension (mm): pls. see drawing
Mounting possibilities: Backside – DIN-Rail
Lid
Lid Mounting: Thickness 1-6mm

Certificates

ATEX, IECEX, EAC TC-RU

Marking

⊕ II 2G Ex e IIC Gb / ⊕ II 2D Ex tD A21 IP66

Order no.

Pls. see next page

QX-0205...





Ex Ampere- / Voltmeter

Erfahrung ist Zukunft



Local Control Components

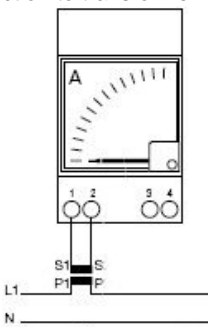

Voltmeter, rail mounting:	Calotte	Measuring method	Overload factor	Measuring range	Order Number QX-0205-
	EXM	Voltage AC		0-25V 0-40V 0-150V 0-250V 0-500V	M□V 25 M□V 40 M□V 150 M□V 250 M□V 500
Ammeter, rail mounting: 		Current AC/DC (0)4-20mA	2	0-20 / 40mA 4-20 / 40mA	M□MA 11 M□MA 12
Ammeter, lid mounting: 		Current AC direct measurement	2	0-1 / 2A 0-4 / 8A 0-5 / 10A 0-10 / 20A 0-15 / 30A	M□DA 1 M□DA 4 M□DA 5 M□DA 10 M□DA 15
Window - EXM: 		Current AC for transformer	2	0-1 / 2A 0-2.5 / 5A 0-5 / 10A 0-15 / 30A 0-25 / 50A 0-40 / 80A 0-50 / 100A 0-60 / 120A 0-75 / 150A 0-100 / 200A 0-150 / 300A 0-200 / 400A 0-250 / 500A 0-300 / 600A 0-400 / 800A 0-500 / 1000A 0-600 / 1200A	M□WA 01 / □ -2 M□WA 2.5 / □ -2 M□WA 5 / □ -2 M□WA 15 / □ -2 M□WA 25 / □ -2 M□WA 40 / □ -2 M□WA 50 / □ -2 M□WA 60 / □ -2 M□WA 75 / □ -2 M□WA 100 / □ -2 M□WA 150 / □ -2 M□WA 200 / □ -2 M□WA 250 / □ -2 M□WA 300 / □ -2 M□WA 400 / □ -2 M□WA 500 / □ -2 M□WA 600 / □ -2
Connection to transformer: 		Current AC for transformer	5	0-1 / 5A 0-2.5 / 12.5A 0-5 / 25A 0-15 / 75A 0-25 / 125A 0-40 / 200A 0-50 / 250A 0-60 / 300A 0-75 / 375A 0-100 / 500A 0-150 / 750A 0-200 / 1000A 0-250 / 1250A 0-300 / 1500A 0-400 / 2000A 0-500 / 2500A 0-600 / 3000A	M□WA 01 / □ -5 M□WA 2.5 / □ -5 M□WA 5 / □ -5 M□WA 15 / □ -5 M□WA 25 / □ -5 M□WA 40 / □ -5 M□WA 50 / □ -5 M□WA 60 / □ -5 M□WA 75 / □ -5 M□WA 100 / □ -5 M□WA 150 / □ -5 M□WA 200 / □ -5 M□WA 250 / □ -5 M□WA 300 / □ -5 M□WA 400 / □ -5 M□WA 500 / □ -5 M□WA 600 / □ -5
6 – rail mounting 7 – lid mounting Connection to transformer: 1A = 1 5A = 5					



QX-02/4031/1

Label

This label is used for identification of local control components and will be supplied laser engraved on demand.



QX-02/4031/4

Label large

This label is used for identification of large selector switches and will be supplied laser engraved on demand.



QX-02/4003/1

Emergency-Stop label, round

For sticking on the surface under the button



QX-02/4003/2

Emergency-Stop label, crosswise

For sticking on the surface under the button



QX-02/4009-25

Overhanging part

The overhanging part is used for the buttons of hoist and other moveable control functions together with M25 glands



QX-02/4006

Socket Spanner

This tool is used for mounting of operators in the lid.



QX-02/4019

Safety flap, with clear lid

This will avoid accidentally use of the operators



QX-02/4019/3-7

Safety flap for Pushbutton, lockable, with clear lid

This will avoid accidentally use of the operators



QX-02/4019/2

Safety catch / Shroud for Emergency stop button

To prevent from accidentally use of the Emergency stop button.



QX-02/4019/2+9

Safety catch / Shroud for Emergency stop button lockable

To prevent from accidentally use of the Emergency stop button. Furthermore the Emergency stop button can be fixed and interlocked by a bow.